

**\$79,995\*** Delivered to Site & Set Up

**4 BEDROOM 2 BATH** Price includes heat pump, two 4x6 steps + deck, plumbing under home, concrete footings, brick skirting, electrical 200 amp service (home only), setup, blocked & tied down & county permit. \*Plus Tax & Title

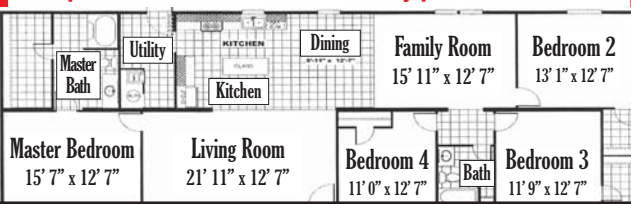

No land improvements are included.

2008 E Roosevelt St (Hwy 74)

Monroe • 704-225-8850

www.1stchoicemonroe.com



## Young Professional Anson Application Deadline is October 20

The Anson County Chamber of Commerce is searching for local young professionals with a passion for our mission to bring people together and serve the community. Applications are available for the Young Professionals Anson executive committee and general membership for the January 2018 kick-off.

The Anson County Chamber of Commerce is committed to growing Anson County by working to connect our young professionals, and providing them with the tools to become invested members of the business community and our future leaders. Anson County Chamber Young Professionals was created to provide an environment for individuals between the ages of 21 to 39 to meet and develop both socially and professionally. Networking opportunities, involvement with Anson County Economic Development initiatives, volunteering and mentoring opportunities and other events will include educational programming with guest speakers.

If you or someone you know is interested, please download the application at [www.ansoncountychamber.org/young-professionals](http://www.ansoncountychamber.org/young-professionals). The application deadline is October 20. Questions can be emailed to Megan Sellers at [msellers@ansoncountychamber.org](mailto:msellers@ansoncountychamber.org).

## Free Groceries for Families in Need November 1

For families in need, free groceries will be available. The Mobile Food Pantry and CHS Mobile Health Unit will be at Austin Grove Baptist Church, located at 5919 Austin Grove Church Road in Marshville, on Wednesday, November 1. Please arrive and register between 8:30 and 11 a.m. The food distribution begins upon the truck arrival, usually between 10 to 10:30 a.m.

• Be sure to bring your own bags, boxes or carts to carry your food. • Arrive between 9:30 to 11 a.m. to be sure you can receive food. • If it is raining the day of or before the delivery, contact Anson Crisis Ministry for a recorded message to know if it is cancelled: 704-694-2445. • You can only pick up food for yourself and one other registered household.

Interested in volunteering for the Mobile Food Pantry? Email [hvuillagrana@wnccumc.net](mailto:hvuillagrana@wnccumc.net).

The goal of the Mobile Food Pantry is to feed the hungry and serve those in need.

If you are in need before or after the distribution of food date, please contact Anson Crisis Ministry at (704) 694-2445 or Union County Crisis Assistance at (704) 225-0440.

## USDA Processing Pending Conservation Reserve Program Continuous Enrollment Offers

**Acceptance of most 2018 offers temporarily suspended**

The U.S. Department of Agriculture (USDA) announced today that it will process many pending eligible offers for land enrollment in the Conservation Reserve Program (CRP), and it will temporarily suspend accepting most new offers until later in the 2018 fiscal year.

"All current, eligible CRP continuous enrollment offers made through Sept. 30, 2017 – except for those made under the Pollinator Habitat Initiative (CP42) – will be approved," said Steven J. Peterson, Acting Farm Service Agency (FSA) Administrator. "Additionally, we are temporarily suspending acceptance of most offers going forward to provide time to review CRP allocation levels, and to avoid exceeding the statutory cap of 24 million acres."

The CRP acreage cap is a provision of the 2014 Farm Bill. Current enrollment is about 23.5 million acres nationwide. USDA is accepting all pending continuous enrollment offers that were made beginning on May 4, 2017, and extending through Sept. 30, 2017, except Pollinator Habitat Initiative offers. Pollinator acreage offers are being declined because the program has met its acreage enrollment goal. Effective immediately, USDA is suspending acceptance of all new CRP continuous offers received or submitted after Sept. 30, 2017. The suspension will continue until later in the 2018 fiscal year.

Peterson said, however, that USDA will continue to accept eligible offers for state-specific Conservation Reserve Enhancement Program (CREP) and CRP Grasslands enrollment. Offers received on or after Oct. 1, 2017, are subject to fiscal year 2018 rental rates which have been adjusted to reflect current market conditions and were established after careful review of the latest USDA National Agricultural Statistics Service cash rent data.

In return for enrolling in CRP, USDA, through FSA, provides participants with rental payments and cost-share assistance. Landowners enter into contracts that last between 10 and 15 years. CRP pays farmers and ranchers who remove sensitive lands from production and plant certain grasses, shrubs and trees that improve water quality, prevent soil erosion and increase wildlife habitat. Payment totals for 2017 were announced earlier this week totaling over \$1.6 billion.

Signed into law by President Reagan in 1985, CRP is one of the largest private-lands conservation program in the United States. Thanks to voluntary participation by farmers and landowners, CRP has improved water quality, reduced soil erosion and increased habitat for endangered and threatened species.

For more information about CRP, contact your local FSA office (704-694-3516) or visit [www.fsa.usda.gov/crp](http://www.fsa.usda.gov/crp). To locate your local FSA office, visit [offices.usda.gov](http://offices.usda.gov).

## McLeod Health Introduces Pregnancy App

McLeod Health announces the launch of a free McLeod Motherhood App. Becoming a mother is an exciting journey, and the McLeod Motherhood App serves as a step-by-step guide to pregnancy. Learn what to expect and when, track your progress, and get valuable information on a healthy pregnancy, giving birth, breastfeeding, and parenting. Women can even create a personal journal for all those special moments along the way.

Special features include: week-by-week pregnancy milestones, an appointment tracker, weight tracker for mom and baby, kick counter, contraction timer, journal and more.

Stay connected with McLeod Health throughout pregnancy and beyond by downloading the FREE McLeod Motherhood app to an iPhone, iPad or Android device.

To download the app, visit [www.mcleodmotherhood.org](http://www.mcleodmotherhood.org), the Apple App Store or Google Play.

## Become a Volunteer for Hospice

Hospice of Anson County in association with Hospice of Union County would love to have you join their volunteer team. Volunteers must be 16 years old or older to participate. There are opportunities for patient and family care volunteers, administrative volunteers, and community volunteers.

For more information on volunteer opportunities, please contact 980-993-7300 or [VolunteerHospice@CarolinasHealthCare.org](mailto:VolunteerHospice@CarolinasHealthCare.org).

Caring for hospice patients and families in our community for over 30 years.

## Mrs. Mary "Frances" Kiker

Mrs. Mary "Frances" Kiker, 83 years of age, of Polkton, passed away Sunday, October 15, 2017, at her home.

The funeral service was held on Tuesday, October 17, 2017, at Hopewell United Methodist Church in Peachland, officiated by Rev. Paul McClure. Burial followed at the church cemetery.



Frances was born November 29, 1933, in Anson County, NC to the late Fred Jones Kirk and the late Nora Mae Kirk.

She was also preceded in death by husband, Charles Craven Kiker; brother, Joe Kirk; and two son-in-laws, Ellis Lawhon and Steve Thomas.

Survivors include her daughter Susan Lawhon of Polkton; two grandsons, John (Connie) Thomas of Polkton and Jamie (Robin) Lawhon of Peachland; granddaughter Kim (Chuck) Polson of Polkton; five great-grandchildren, Tabitha and Levi Thomas, Marissa Polson, Taylor Lawhon and Caleb Mayhall; her brother Tommy Mathis; and her beloved Chihuahua Patches.

Memorials may be made to Hopewell United Methodist Church, 1715 Hopewell Church Rd, Peachland, NC 28133.

Hartsell Funeral Home of Albemarle is serving the Kiker family.

Online condolences may be made at [www.hartsellfh.com](http://www.hartsellfh.com).

## Mr. Randall Truesdale Crenshaw

Mr. Randall Truesdale Crenshaw, 92, of Ansonville passed away on Monday, October 16, 2017.

Funeral services will be held at 11:00 a.m. on Saturday, October 21, 2017 at Ansonville United Methodist Church with Rev. Robert Burr officiating. The family will receive friends from 6 to 8 p.m. on Friday evening, October 20, 2017, at Edwards Funeral Home in Norwood.

Mr. Crenshaw was born September 10, 1925, in Cassatt, SC to the late James William and Pauline Walters Crenshaw. He was a US Navy veteran, having served during World War II. He was a farmer and retired manager of Crossroads Grocery in Van Wyck, SC. Mr. Crenshaw was a member of Ansonville United Methodist Church. He was a true Biblical scholar, committing to reading the entire Bible every year.

In addition to his parents, he was preceded in death by four brothers and three sisters.

He is survived by his wife of 67 years, Charlotte Ingold Crenshaw of the home; his sister Yuline Crenshaw Newell of Mineral Springs; and his nieces and nephews.

Memorials may be made to Bethlehem Cemetery Fund, P. O. Box 421, Ansonville, NC 28001.

Online condolences: [edwardsfuneralhomes.com](http://edwardsfuneralhomes.com).



## Marlene Murphy Martin

Marlene Murphy Martin 63 of Ansonville died Saturday Morning, October 14, 2017 at CHS-Stanly.

Funeral Services were held on Tuesday, October 17, 2017, at Red Hill Baptist Church with Rev. Rodney Clements officiating. Burial followed in the church cemetery.

Marlene was born February 12, 1954, in Harriman, Tennessee to the late Richard Phineas and Madeliene Fletcher Murphy. She enjoyed her career

serving with Anson County Schools, Sandhills Mental Health and retiring from BB&T. She was a long time active member of Red Hill Baptist Church where she enjoyed the Christian Service Sunday School Class, teaching Sunday School and singing in the choir.

To say Marlene was a "People Person" would be an understatement. She loved meeting people and making new friends wherever she went, spending time with old friends, walking, swimming at the YMCA and the Bunco Club just to mention a few. She was an accomplished craftsman, doing needlepoint, cross-stitching, making blankets and toboggans.

It's hard to sum up a remarkable and well lived life in a few words, but Marlene's family will always cherish her memory. Remembering her love of reading and encouraging her grandchildren to read. Going to ball games, recitals, spending time at the lake, trips to the beach, working in her flowers and her cooking skills, especially her famous "Green Beans" and "Lasagna." Her early morning phone calls and hearing "Gobble Gobble" first thing on Thanksgiving mornings.

She is survived by her husband, Argus Lincoln Martin, Jr. of the home; two sons, Linc Martin and wife Jeania and Jason Martin and wife Erin, all of Ansonville; her grandchildren, Walt, Jack, Camryn and Jase Martin; two brothers, Richard Murphy, Jr. and wife Patricia of Winston-Salem and Michael Murphy and wife Susan of Laurinburg; a sister, Linda Murphy of Spartanburg, SC; her mother-in-law Sara Edwards Martin of Ansonville; her sister-in-laws Carol Martin McGauran and husband Michael of Mt. Pleasant, SC and Rena Martin Creech of Albemarle; and many loving nieces and nephews.

In lieu of flowers memorials may be made to the Christian Service Class, Red Hill Baptist Church, 4747 Red Hill Mt. Vernon Road, Polkton, NC 28135.



**COME SEE OUR NEW RECLINING SOFA & LOVESEAT WITH ADJUSTABLE HEADRESTS**

**WE FINANCE EZ TO APPLY OWN IT NOW!**



**VISIT OUR SLEEP SHOP**

**We have HEATERS KEROSENE · GAS ELECTRIC · WOOD**

**MARTIN FURNITURE FACTORY OUTLET**

Highway 74 West in Wadesboro • 704-694-3185

**WATER HEATERS**

**LOCAL DELIVERY \$25 Check Our Clearance Section**